

PERSONAL

Setting up MMS

How to set up MMS on your
Android device

Telkom

How do I set up MMS on my Android phone?*



Manually setting up MMS

(NB: Ensure the Internet is working fine before setting up the MMS)

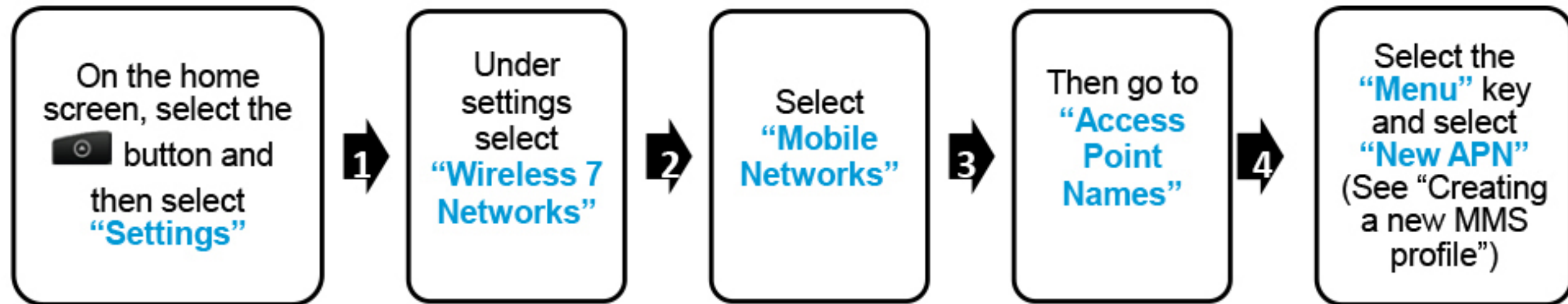

1 Legend:
= Step Number

**Please note: some menu options may differ for different Android phones*

How do I set up MMS on my Android phone?*



Creating a new MMS profile
(Enter the following parameters)

| | |
|---------------------------|--|
| Name – 8.ta. MMS | MMSC – http://mms.8ta.com:38090/was |
| APN – mms | MMS Proxy – 41.151.254.162 |
| Proxy – blank | MMS Port – 8080 |
| Port – blank | MMS Protocol – WAP 2.0 |
| Username – leave it blank | MCC – 655 |
| Password – leave it blank | MNC – 02 |
| Server – blank | Authentication type – CHAP |
| | Type APN – mms |

Select the **Menu** key and select **“Save”**

**Please note: some menu options may differ for different Android phones*