

PERSONAL

# Setting up WiFi

How to setup the Apple iPad to connect to your ADSL via WiFi.

**Telkom**

## Setup the Ipad to connect to your ADSL via WiFi

Turn the device on by holding the power button until the boot-up screen appears and wait until the desktop is visible. On the homepage touch on the settings icon

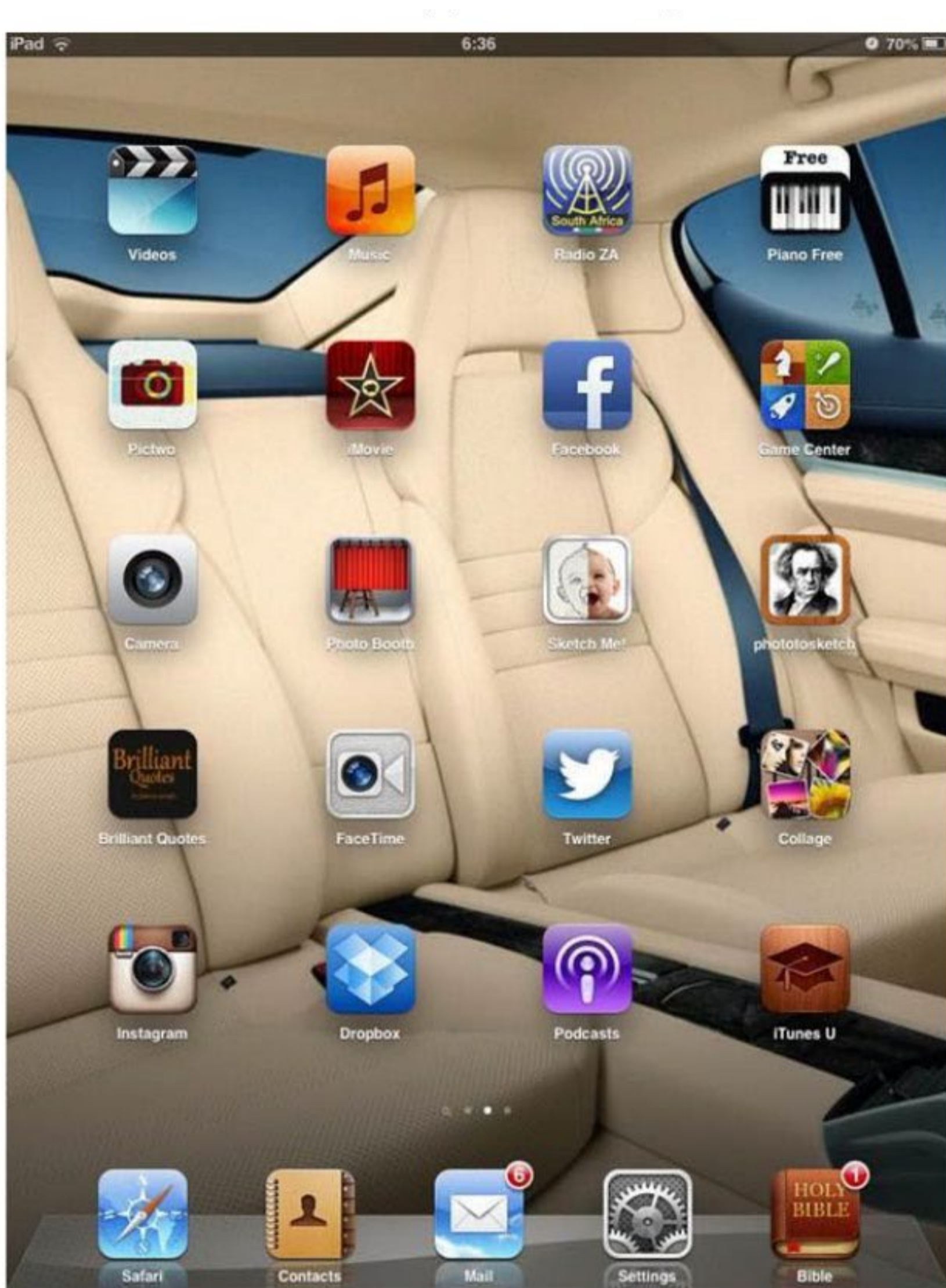



On the settings menu touch on the **Wireless & Networks** option



In WiFi Settings change **WiFi** to **On**.

You will now see all the WiFi access points in range of the device touch your access point



It will open the security window where you will have to enter the WEP/WPA key (the key can normally be found on the bottom of the ADSL WiFi router) to authenticate to the router.

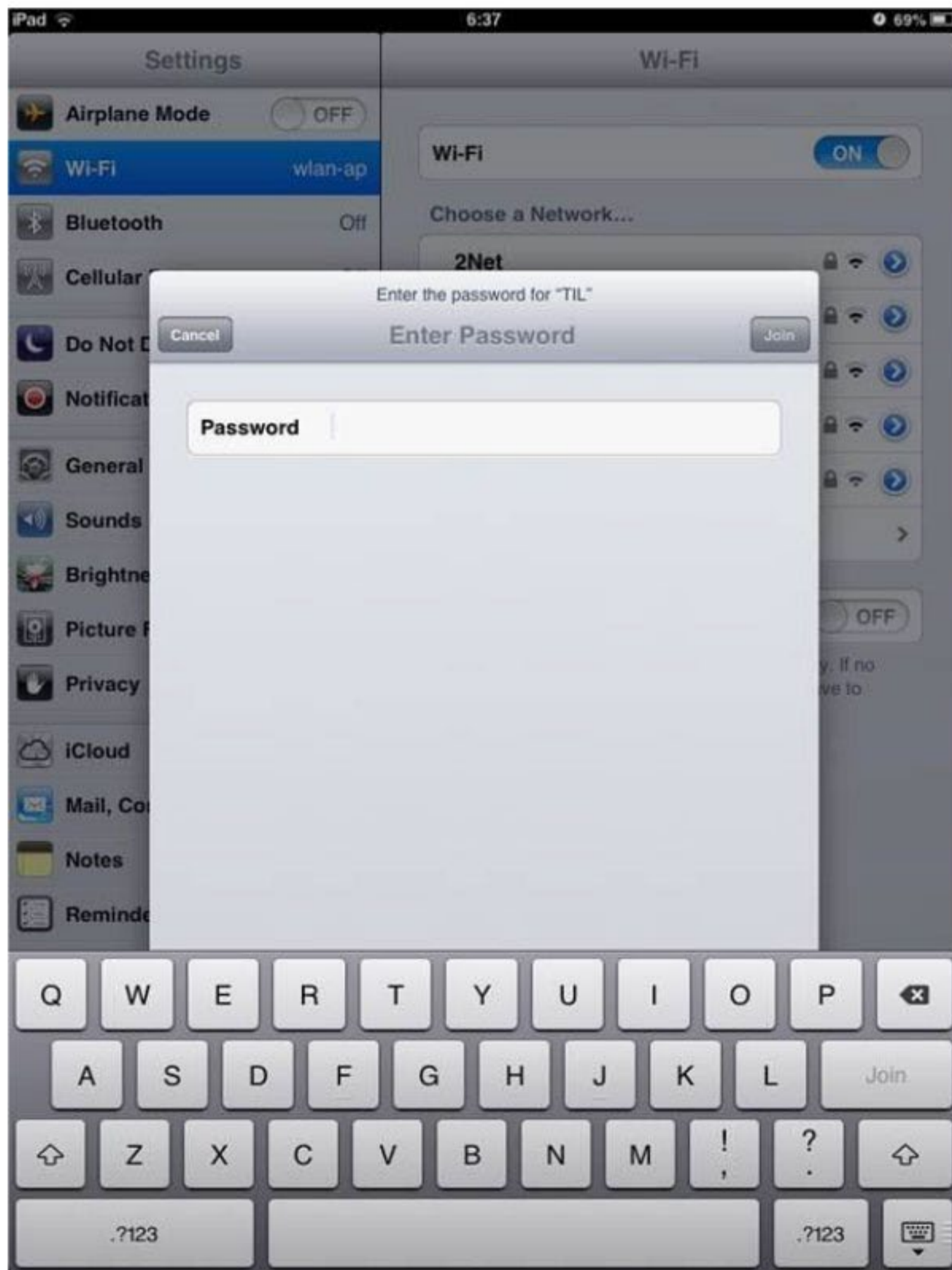



Once the Wpa/WPA2PSK keys have been entered correctly the access point should change to connected. And display the IP address.



Note:

Please remember that you are ADSL router has to be configured to connect to the internet for you to be able to connect via the iPad.

To remove/Unsave a previous/old access point key simply touch on the forget this network

